

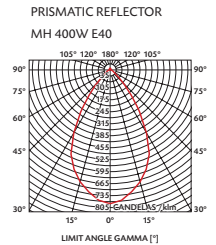

The High Bay is an excellent all round performance high bay luminaire rated for ingress at IP20. The two piece housing is manufactured in injection moulded thermo plastic polycarbonate UV and heat stabilised, the standard colour is white, also available in a wide range of vibrant RAL colour options. The housing is supported and suspended by an integral metal frame. Available with the choice of aluminium or clear acrylic prismatic reflectors and options of toughened glass or clear acrylic bottom lenses.

Good photometric performance with an E40 fixed non-adjustable lamp holder assembly and polished aluminium or prismatic reflectors. Suitable for a wide range of applications including commercial, retail and industrial environments. Auxiliary versions available with halogen lamp.

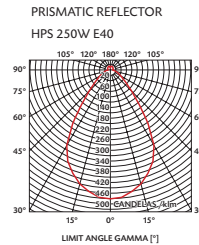

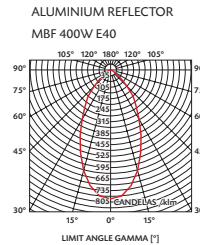
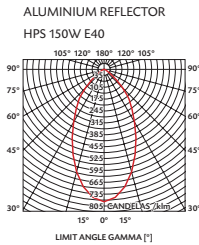
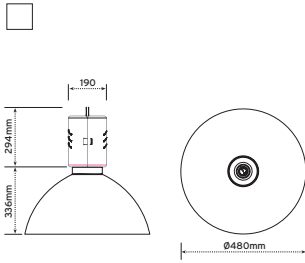

- S.3 - SON-E (E40) External ignitor
- M.2 - MBF/U (E40)
- H.4 - Metal Halide (E40)



DESCRIPTION	LAMP	Wt.(kg)
-------------	------	---------

SPUN ALUMINIUM REFLECTOR IP20

HIGH PRESSURE SODIUM		
150W	S.3	5.90
250W	S.3	7.50
400W	S.3	8.70
MERCURY BLENDED FLU.		
250W	M.2	5.80
400W	M.2	7.50
METAL HALIDE		
150W *	H.4	5.90
250W *	H.4	6.00
400W *	H.4	7.90



ACRYLIC PRISMATIC REFLECTOR IP20

HIGH PRESSURE SODIUM		
150W	S.3	7.90
250W	S.3	9.50
400W	S.3	10.70
MERCURY BLENDED FLU.		
250W	M.2	7.80
400W	M.2	9.50
METAL HALIDE		
150W *	H.4	7.90
250W *	H.4	8.00
400W *	H.4	9.90

TECHNICAL SPECIFICATION

HOUSING	Injection moulded polycarbonate
REFLECTORS	Aluminium or clear acrylic prismatic
CONTROL GEAR	Available with a wide variety of options Metal halide control gear 250W & 400W is Mercury based
ACCESS	Removable cover

ACCESSORIES - ALUMINIUM REFLECTOR

- Clear polycarbonate diffuser
- Steel wire guard
- Toughened BS glass visor
- Auxiliary version
- Open rated lamp available for metal halide
- Timed ignitor

ACCESSORIES - PRISMATIC REFLECTOR

- Dished lens
- Open rated lamp available for metal halide
- Timed ignitor

* Cover required for metal halide